

**GC & P Development, LLC.**  
 Located in the City of Wheeling, Wheeling District,  
 Ohio County, West Virginia

**Future Development  
 Initial Grading - 1030 Bench**

**HAMILTON**  
 A Subsidiary, Inc.  
 342 High St., Box 471  
 Fishing, Ohio 43977  
 PH: (740) 968-4947  
 FAX: (740) 968-4225  
 www.hamiltoninc.com

NO.	DATE	DESCRIPTION	BY	CHKD

REVISIONS

DATE: 03-18-2012  
 DRAWN BY: JLL  
 SHEET: D-1

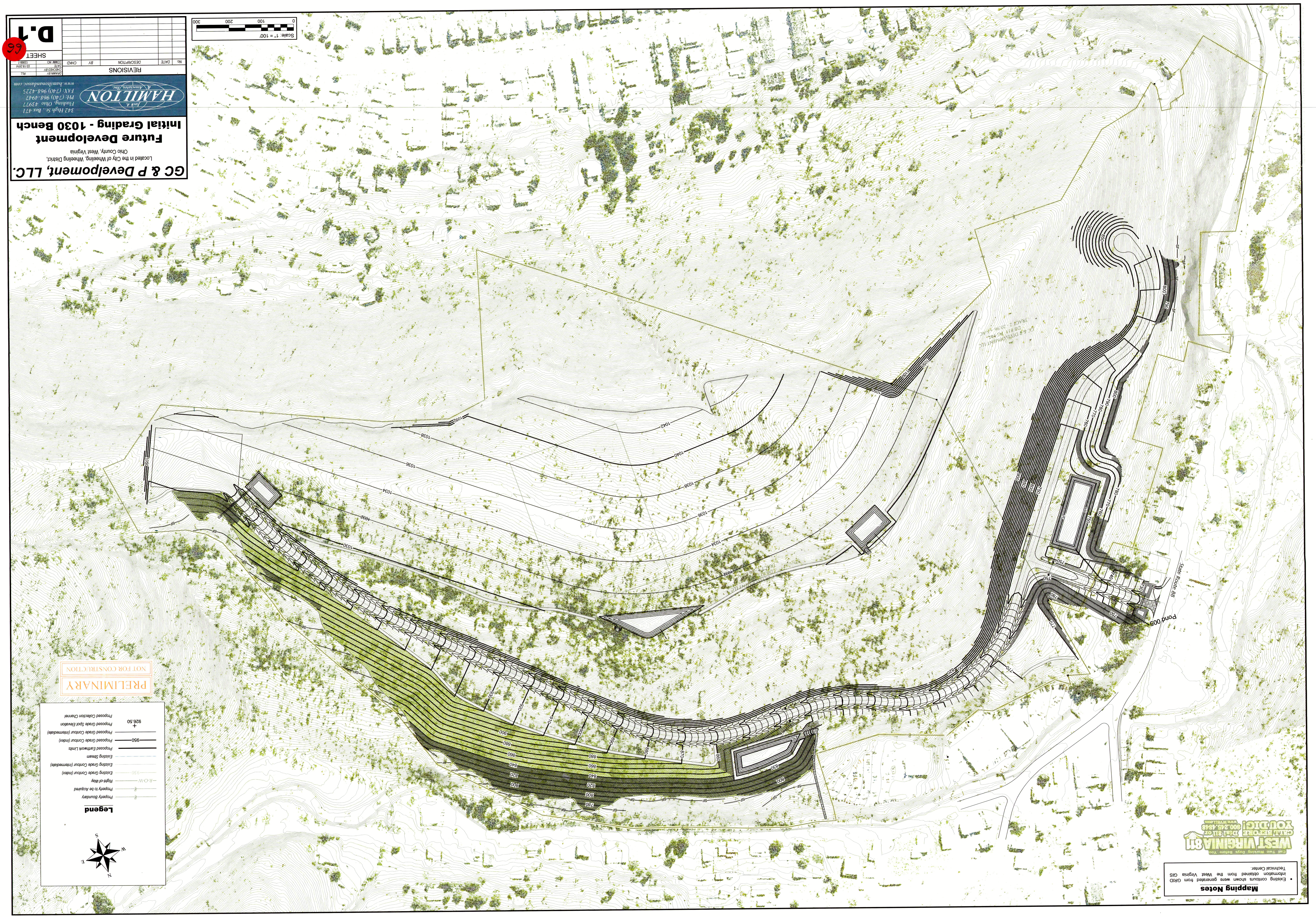
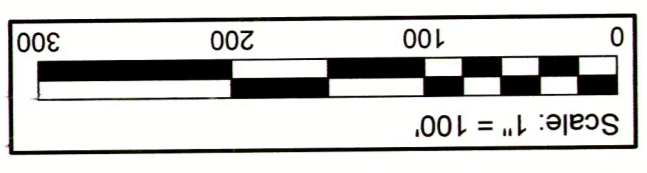

**PRELIMINARY**  
 NOT FOR CONSTRUCTION

**Legend**

- +— Proposed Grade Spot Elevation
- Proposed Grade Contour (intermediate)
- 950— Proposed Grade Contour (index)
- Proposed Easement Limits
- Existing Stream
- Existing Grade Contour (intermediate)
- 950— Existing Grade Contour (index)
- R-O-W— Right-of-Way
- Property to be Acquired
- Property Boundary
- Proposed Collection Channel

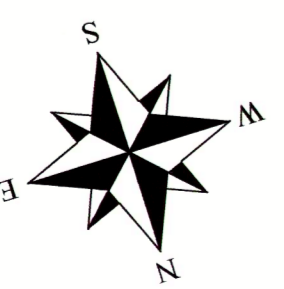

**Mapping Notes**

- Existing contours shown were generated from GIS
- Information obtained from the West Virginia  
 Technical Center.

**WEST VIRGINIA 311**  
 Call Two Ways: Dope Before You  
 Call Before You Dig! 800.245.4548  
 www.wv311.com